



KONICA MINOLTA

# AccurioPro Label Impose

## Category



Make-Ready

## Characteristics

- Templates
- Colour split
- Job editing

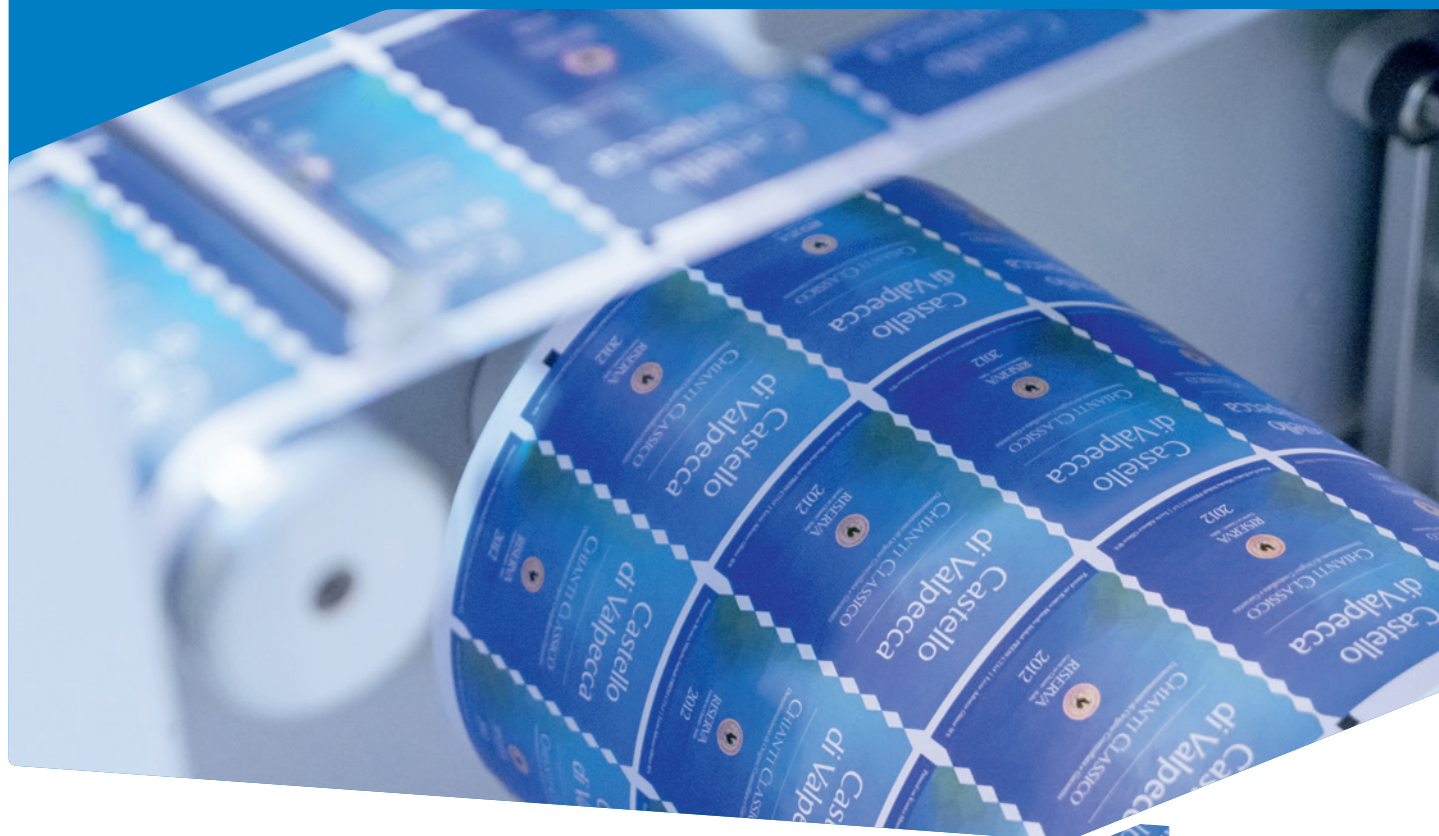

**AccurioPro**  
Label Impose



# INDISPENSABLE TOOL FOR AUTOMATED LABEL PRINTING

**For reasons of efficiency and economy, printing companies involved in the production of labels need to automate and integrate this task as much as possible. Similarly important is the optimised use of media in order to avoid any waste of the label substrate. This is why in general several labels are imposed across the width and length of the label web – which, when having to be done manually, can easily become a complicated and time-consuming procedure.**

The AccurioPro Label Impose software tool provides the perfect solution to this challenge: The application not only gives operators a simple and intuitive interface to automatically impose and prepare label jobs for printing. At the same time, the software also enables users to create PDFs as basis for the corresponding cutting tools on the die cutting equipment. Working seamlessly with the AccurioLabel 190, AccurioPro Label Impose perfectly complements Konica Minolta's label press!

AccurioPro Label Impose impresses with its PDF-based workflow, which also facilitates creating the correct data input for the creation of die tools, its VDP support, intuitive user interface and large print area of 320 x 480 mm. Print providers can't go wrong with the combination of the AccurioLabel 190 and AccurioPro Label Impose!

# KEY FEATURES

## Job editing

- **Automatic creation of label repetitions:** The application facilitates and automates the creation of label repetitions on the label web.
- **Variable data content:** The processing of variable data content is simple and straightforward and can easily be incorporated into the automatic label repetitions.
- **Adjustable spacing:** Operators have the freedom to adjust the spacing between columns and rows individually and as required.
- **Adding standard and custom eye marks:** The application offers complete flexibility in adding standard and custom eye marks in any desired position for offline finishing.
- **Arranging artwork:** Users can choose between automatic and manual arrangement of artwork for the label layout.
- **Gang-up printing:** A single sheet can be imposed with just one or various selected artwork motifs.
- **Die cutting tools:** With the ability to detect additional separations (die lines, spot varnish, foil, etc.) and export them to PDF, AccurioPro Label Impose facilitates the production of the die cutting tools and enables additional decorations on labels.



# WORKFLOW

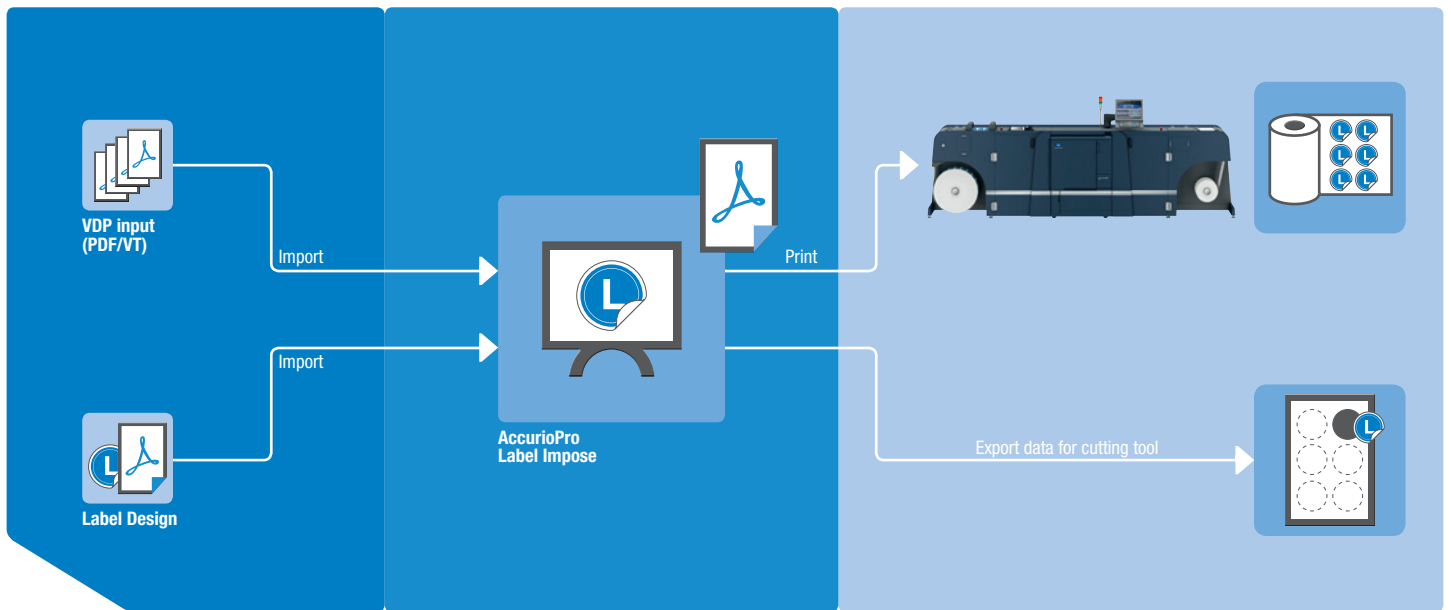

# TECHNICAL SPECIFICATIONS

## RECOMMENDED REQUIREMENTS

<b>Operating systems</b>	Windows 7 Pro (64 Bit) Windows 8.1 Pro (64 Bit) Windows 10 Pro (64 Bit)
<b>Memory</b>	2 GB RAM
<b>Disk space</b>	1 GB
<b>CPU</b>	Intel i5 dual core or equivalent
<b>Screen resolution</b>	1.280 x 720 pixels

